

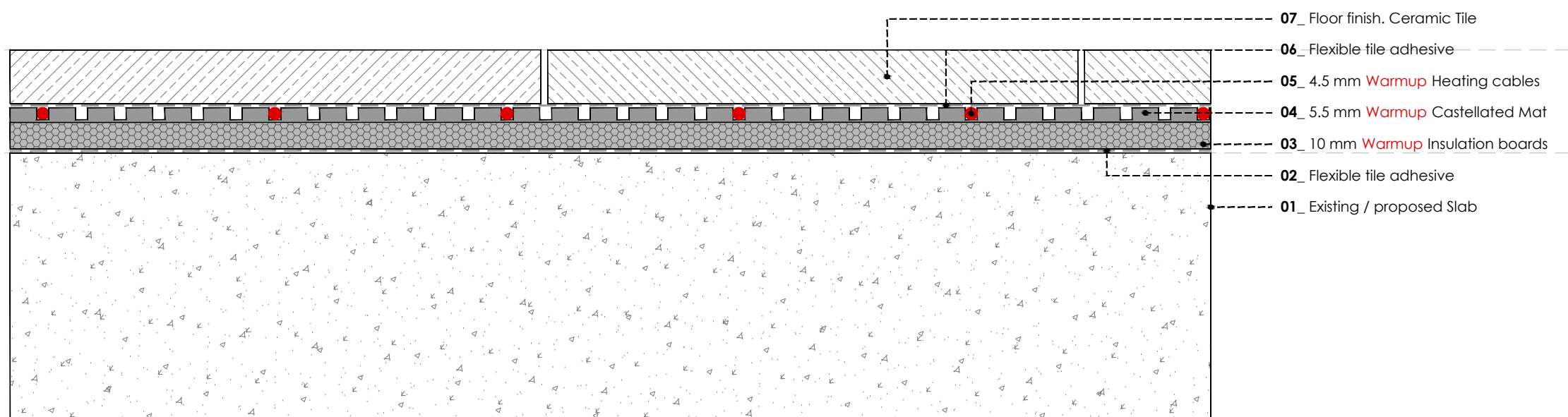

Proposed FFL

Existing FSL



WARMUP CASTELLATED MAT SYSTEM.
CONCRETE SUBFLOOR AND TILES (with Warmup insulation boards)

© This drawing is confidential and may not be used, copied or disclosed to anyone without permission of Warmup Plc. The Copyright of these drawings remain the property of Warmup Plc. Do not scale from drawings, all dimensions to be checked on site. The Warmup word and associated logos are trade marks. © Warmup Plc. 2010 - Regd. TM Nos. 1257757, 4409926, 5265707. E & OE. Registered in England No. 2955213.

TITLE: WARMUP CASTELLATED MAT SYSTEM

SCALE: 1.2_A3

DATE: 06.04.2016

DESIGNER: AAM

VERSION: 01

Warmup®

The world's **best-selling** floor heating brand™

WARMUP PLC, 702 Tudor Estate, Abbey Road, London, NW10 7UW
Tel 0845 034 8270 Fax 0208 453 6869
projects@warmup.com www.warmup.co.uk



Proposed FFL

Existing FSL

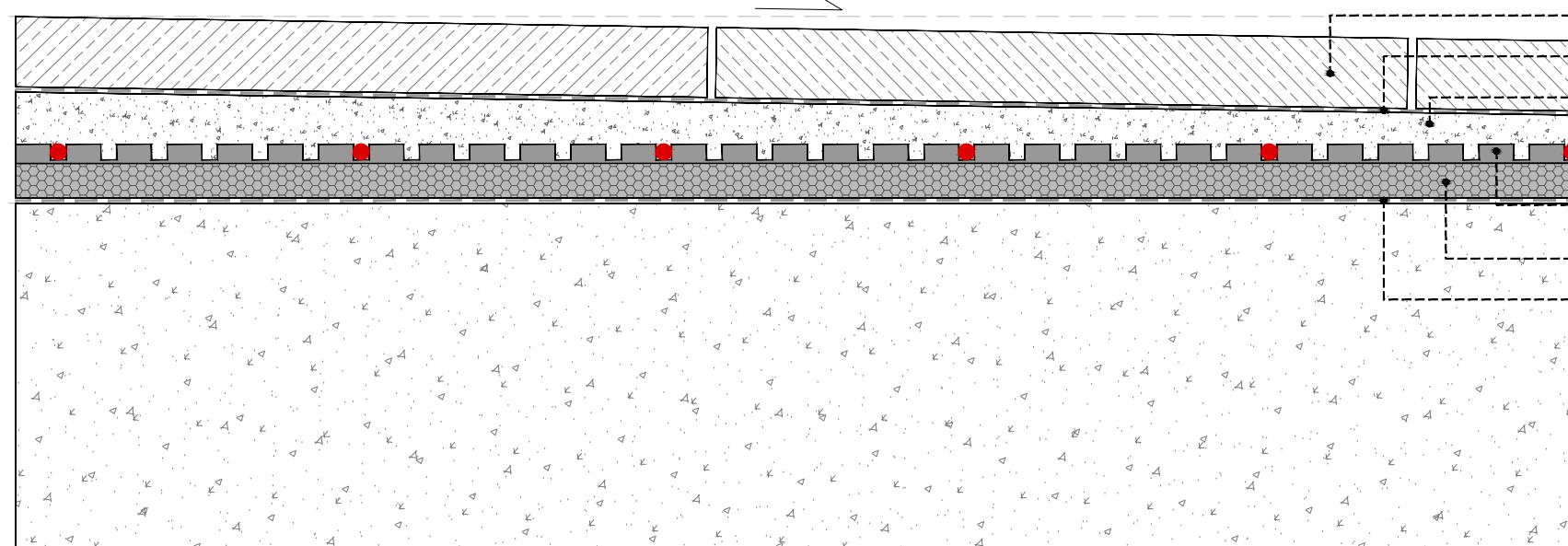

- 08_ Floor finish. Ceramic Tile
- 07_ Flexible tile adhesive
- 06_ 12 mm Self-levelling compound drainage slope to shower drain
- 05_ 4.5 mm Warmup Heating cables
- 04_ 5.5 mm Warmup Castellated Mat
- 03_ 10 mm Warmup Insulation boards
- 02_ Flexible tile adhesive
- 01_ Existing / proposed Slab

**WARMUP CASTELLATED MAT SYSTEM.
CONCRETE SUBFLOOR WITH DRAINAGE SLOPE FOR WETROOMS (with Warmup insulation boards)**

© This drawing is confidential and may not be used, copied or disclosed to anyone without permission of Warmup Plc. The Copyright of these drawings remain the property of Warmup Plc. Do not scale from drawings, all dimensions to be checked on site. The Warmup word and associated logos are trade marks. © Warmup Plc. 2010 - Regd. TM Nos. 1257757, 4409926, 5265707. E & OE. Registered in England No. 2955213.

TITLE: WARMUP CASTELLATED MAT SYSTEM

SCALE: 1:2_ A3

DATE: 06.04.2016

DESIGNER: AAM

VERSION: 01

Warmup®

The world's **best-selling** floor heating brand™

WARMUP PLC, 702 Tudor Estate, Abbey Road, London, NW10 7UW
Tel 0845 034 8270 Fax 0208 453 6869

projects@warmup.com www.warmup.co.uk



Proposed FFL

Existing FSL

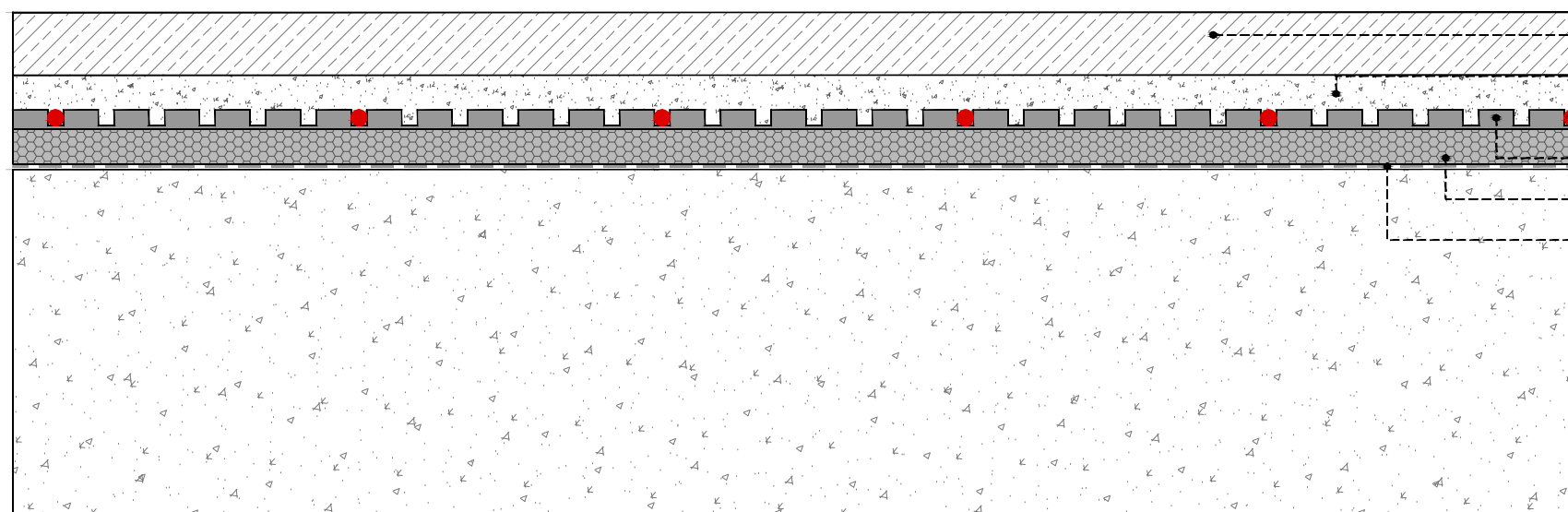

- 07_ Floor finish. Vinyl, Carpet or Wood
- 06_ 10 mm Self-levelling compound
- 05_ 4.5 mm Warmup Heating cables
- 04_ 5.5 mm Warmup Castellated Mat
- 03_ 10 mm Warmup Insulation boards
- 02_ Flexible tile adhesive
- 01_ Existing / proposed Slab

WARMUP CASTELLATED MAT SYSTEM.
CONCRETE SUBFLOOR AND VYNIL, CARPET OR WOOD (with Warmup insulation boards)

© This drawing is confidential and may not be used, copied or disclosed to anyone without permission of Warmup Plc. The Copyright of these drawings remain the property of Warmup Plc. Do not scale from drawings, all dimensions to be checked on site. The Warmup word and associated logos are trade marks. © Warmup Plc. 2010 - Regd. TM Nos. 1257757, 4409926, 5265707. E & OE. Registered in England No. 2955213.

TITLE: WARMUP CASTELLATED MAT SYSTEM

SCALE: 1:2_A3

DATE: 06.04.2016

DESIGNER: AAM

VERSION: 01

Warmup®

The world's **best-selling** floor heating brand™

WARMUP PLC, 702 Tudor Estate, Abbey Road, London, NW10 7UW
Tel 0845 034 8270 Fax 0208 453 6869

projects@warmup.com www.warmup.co.uk



Proposed FFL

Existing FSL

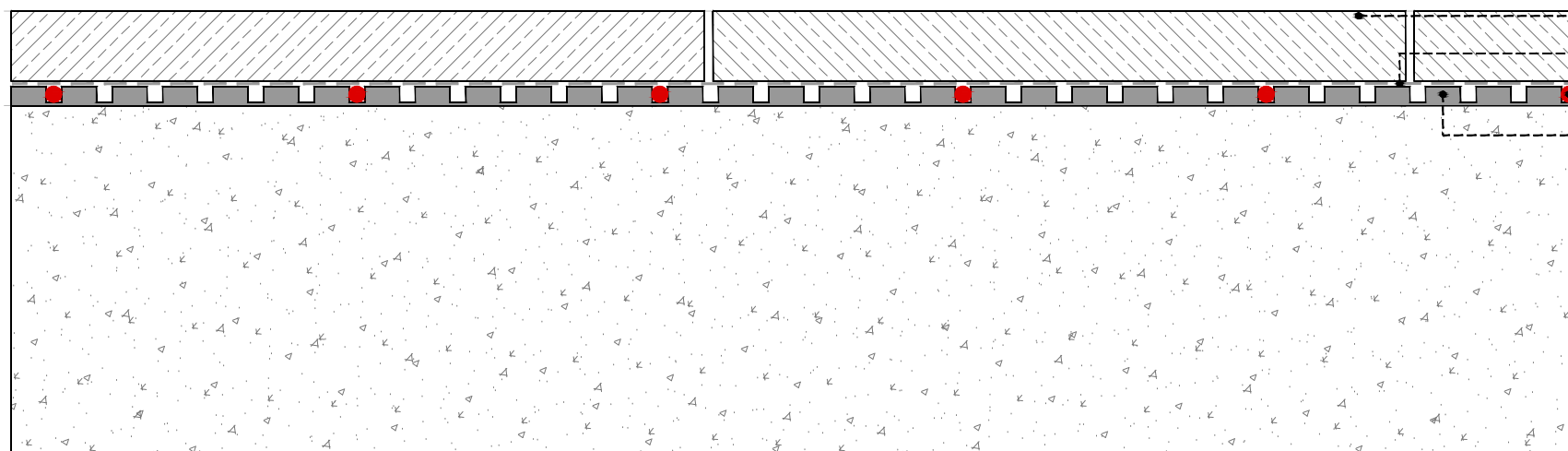

- 05_ Floor finish. Ceramic Tile
- 04_ Flexible tile adhesive
- 03_ 4.5 mm Warmup Heating cables
- 02_ 5.5 mm Warmup Castellated Mat
- 01_ Existing / proposed Slab

**WARMUP CASTELLATED MAT SYSTEM.
CONCRETE SUBFLOOR AND TILES**

© This drawing is confidential and may not be used, copied or disclosed to anyone without permission of Warmup Plc. The Copyright of these drawings remain the property of Warmup Plc. Do not scale from drawings, all dimensions to be checked on site. The Warmup word and associated logos are trade marks. © Warmup Plc. 2010 - Regd. TM Nos. 1257757, 4409926, 5265707. E & OE. Registered in England No. 2955213.

TITLE: WARMUP CASTELLATED MAT SYSTEM

SCALE: 1:2_A3 **DATE:** 06.04.2016

DESIGNER: AAM **VERSION:** 01



The world's **best-selling** floor heating brand™

WARMUP PLC, 702 Tudor Estate, Abbey Road, London, NW10 7UW
Tel 0845 034 8270 Fax 0208 453 6869
projects@warmup.com www.warmup.co.uk



Proposed FFL

Existing FSL

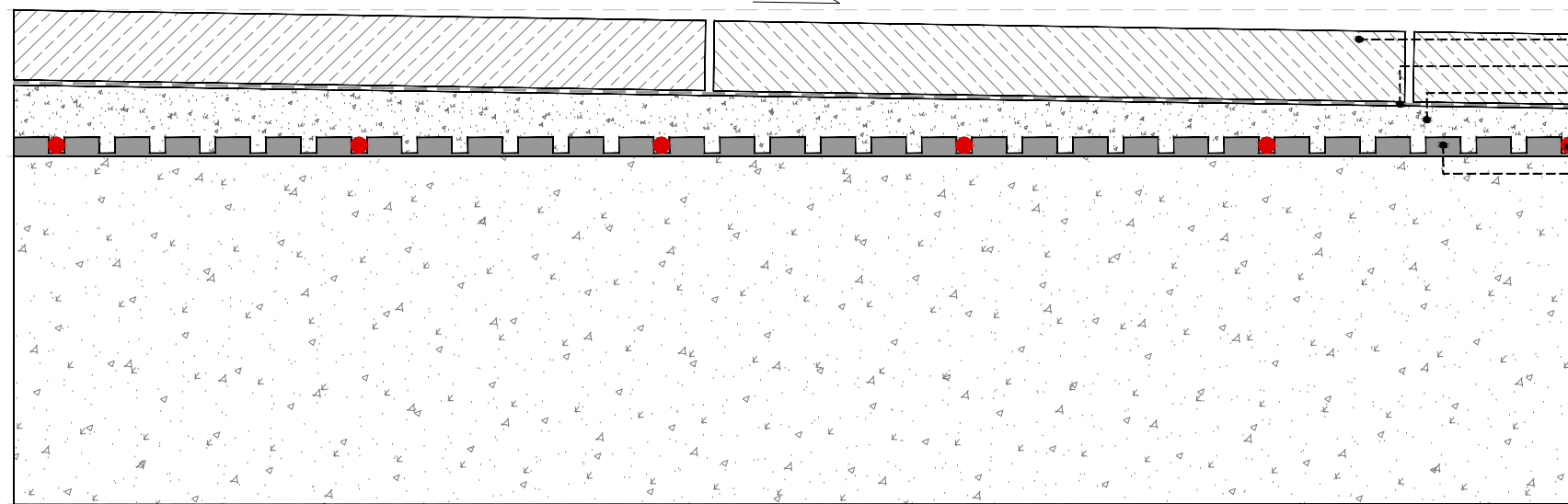

- 06_ Floor finish. Ceramic Tile
- 05_ Flexible tile adhesive
- 04_ 12 mm Self-levelling compound drainage slope to shower drain
- 03_ 4.5 mm Warmup Heating cables
- 02_ 5.5 mm Warmup Castellated Mat
- 01_ Existing / proposed Slab

**WARMUP CASTELLATED MAT SYSTEM.
CONCRETE SUBFLOOR WITH DRAINAGE SLOPE FOR WETROOMS**

© This drawing is confidential and may not be used, copied or disclosed to anyone without permission of Warmup Plc. The Copyright of these drawings remain the property of Warmup Plc. Do not scale from drawings, all dimensions to be checked on site. The Warmup word and associated logos are trade marks. © Warmup Plc. 2010 - Regd. TM Nos. 1257757, 4409926, 5265707. E & OE. Registered in England No. 2955213.

TITLE:	WARMUP CASTELLATED MAT SYSTEM		
SCALE:	1.2_ A3	DATE:	06.04.2016
DESIGNER:	AAM	VERSION:	01



The world's best-selling floor heating brand™

WARMUP PLC, 702 Tudor Estate, Abbey Road, London, NW10 7UW
 Tel 0845 034 8270 Fax 0208 453 6869
projects@warmup.com www.warmup.co.uk



Proposed FFL



Existing FSL

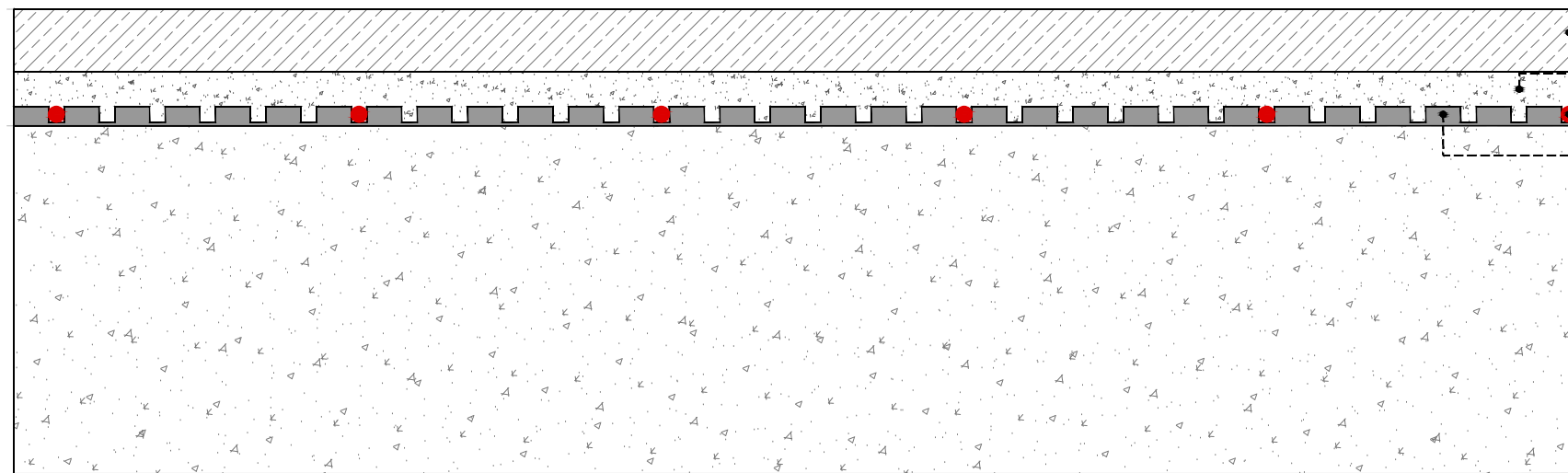

- 05_ Floor finish. Vinyl, Carpet or Wood
- 04_ 10 mm Self-levelling compound
- 03_ 4.5 mm **Warmup** Heating cables
- 02_ 5.5 mm **Warmup** Castellated Mat
- 01_ Existing / proposed Slab

WARMUP CASTELLATED MAT SYSTEM.
CONCRETE SUBFLOOR AND VYNIL, CARPET OR WOOD

© This drawing is confidential and may not be used, copied or disclosed to anyone without permission of Warmup Plc. The Copyright of these drawings remain the property of Warmup Plc. Do not scale from drawings, all dimensions to be checked on site. The Warmup word and associated logos are trade marks. © Warmup Plc. 2010 - Regd. TM Nos. 1257757, 4409926, 5265707. E & OE. Registered in England No. 2955213.

TITLE:	WARMUP CASTELLATED MAT SYSTEM		
SCALE:	1:2_ A3	DATE:	06.04.2016
DESIGNER:	AAM	VERSION:	01

Warmup[®]

The world's **best-selling** floor heating brand™

WARMUP PLC, 702 Tudor Estate, Abbey Road, London, NW10 7UW
Tel 0845 034 8270 Fax 0208 453 6869
projects@warmup.com www.warmup.co.uk

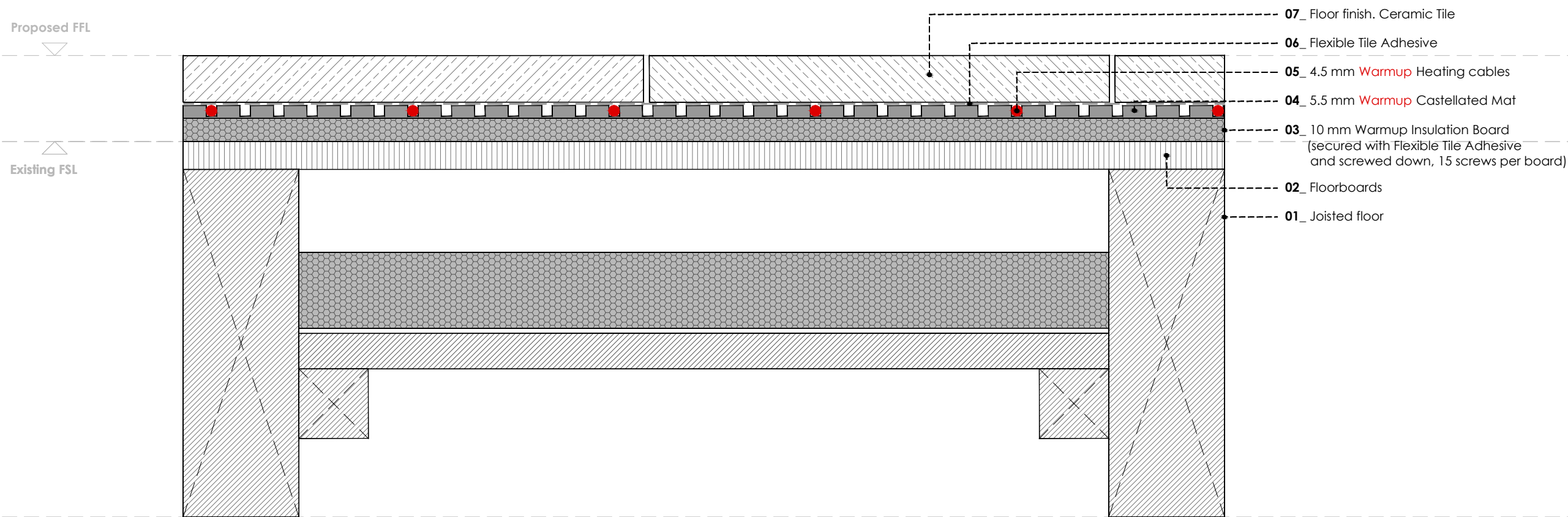

WARMUP CASTELLATED MAT SYSTEM.
TIMBER SUBFLOOR AND TILES (with Warmup insulation boards)

© This drawing is confidential and may not be used, copied or disclosed to anyone without permission of Warmup Plc. The Copyright of these drawings remain the property of Warmup Plc. Do not scale from drawings, all dimensions to be checked on site. The Warmup word and associated logos are trade marks. © Warmup Plc. 2010 - Regd. TM Nos. 1257757, 4409926, 5265707. E & OE. Registered in England No. 2955213.

TITLE: WARMUP CASTELLATED MAT SYSTEM

SCALE: 1.2_A3 **DATE:** 06.04.2016

DESIGNER: AAM **VERSION:** 01

Warmup

The world's **best-selling** floor heating brand™

WARMUP PLC, 702 Tudor Estate, Abbey Road, London, NW10 7UW
Tel 0845 034 8270 Fax 0208 453 6869
projects@warmup.com www.warmup.co.uk

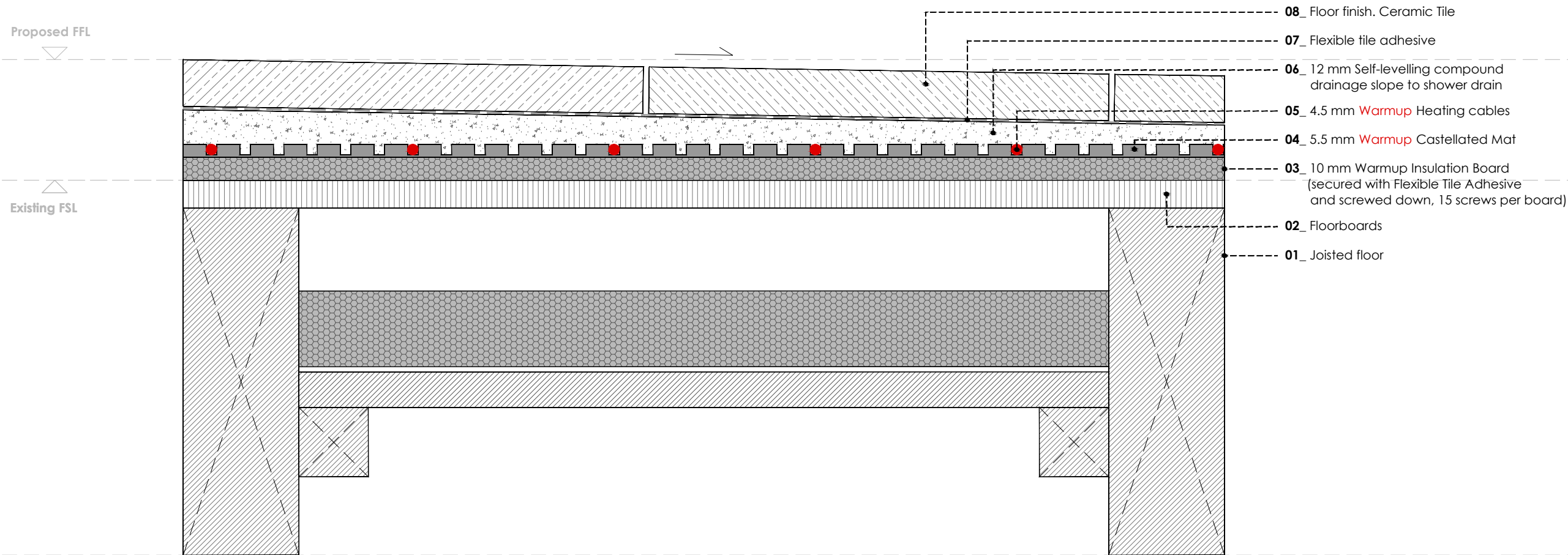

WARMUP CASTELLATED MAT SYSTEM.
TIMBER SUBFLOOR WITH DRAINAGE SLOPE FOR WETROOMS (with Warmup insulation boards)

© This drawing is confidential and may not be used, copied or disclosed to anyone without permission of Warmup Plc. The Copyright of these drawings remain the property of Warmup Plc. Do not scale from drawings, all dimensions to be checked on site. The Warmup word and associated logos are trade marks. © Warmup Plc. 2010 - Regd. TM Nos. 1257757, 4409926, 5265707. E & OE. Registered in England No. 2955213.

TITLE: WARMUP CASTELLATED MAT SYSTEM

SCALE: 1.2_ A3 **DATE:** 06.04.2016

DESIGNER: AAM **VERSION:** 01

Warmup®

The world's **best-selling** floor heating brand™

WARMUP PLC, 702 Tudor Estate, Abbey Road, London, NW10 7UW
 Tel 0845 034 8270 Fax 0208 453 6869
projects@warmup.com www.warmup.co.uk



Proposed FFL

Existing FSL

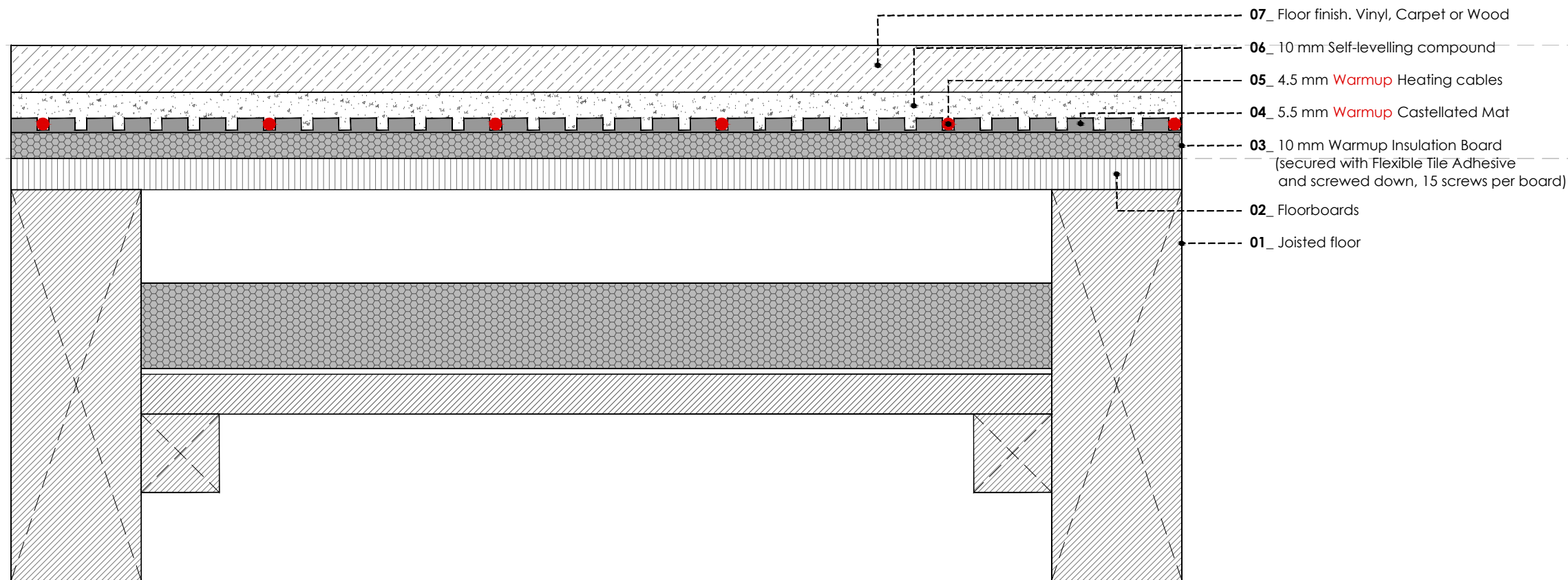

WARMUP CASTELLATED MAT SYSTEM.
TIMBER SUBFLOOR AND VINYL, CARPET OR WOOD (with Warmup insulation boards)

© This drawing is confidential and may not be used, copied or disclosed to anyone without permission of Warmup Plc. The Copyright of these drawings remain the property of Warmup Plc. Do not scale from drawings, all dimensions to be checked on site. The Warmup word and associated logos are trade marks. © Warmup Plc. 2010 - Regd. TM Nos. 1257757, 4409926, 5265707. E & OE. Registered in England No. 2955213.

TITLE: WARMUP CASTELLATED MAT SYSTEM

SCALE: 1.2_ A3 **DATE:** 06.04.2016

DESIGNER: AAM **VERSION:** 01



The world's **best-selling** floor heating brand™

WARMUP PLC, 702 Tudor Estate, Abbey Road, London, NW10 7UW
 Tel 0845 034 8270 Fax 0208 453 6869

projects@warmup.com www.warmup.co.uk

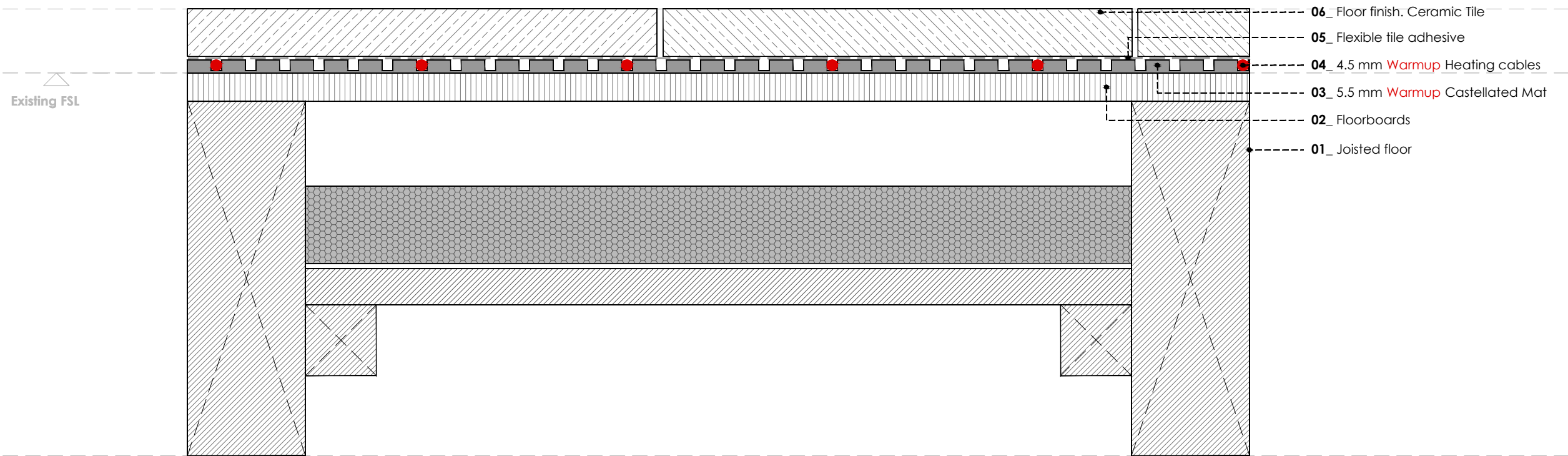

WARMUP CASTELLATED MAT SYSTEM.
TIMBER SUBFLOOR AND TILES

© This drawing is confidential and may not be used, copied or disclosed to anyone without permission of Warmup Plc. The Copyright of these drawings remain the property of Warmup Plc. Do not scale from drawings, all dimensions to be checked on site. The Warmup word and associated logos are trade marks. © Warmup Plc. 2010 - Regd. TM Nos. 1257757, 4409926, 5265707. E & OE. Registered in England No. 2955213.

TITLE: WARMUP CASTELLATED MAT SYSTEM

SCALE: 1.2_A3 **DATE:** 06.04.2016

DESIGNER: AAM **VERSION:** 01

Warmup®

The world's **best-selling** floor heating brand™

WARMUP PLC, 702 Tudor Estate, Abbey Road, London, NW10 7UW
Tel 0845 034 8270 Fax 0208 453 6869
projects@warmup.com www.warmup.co.uk

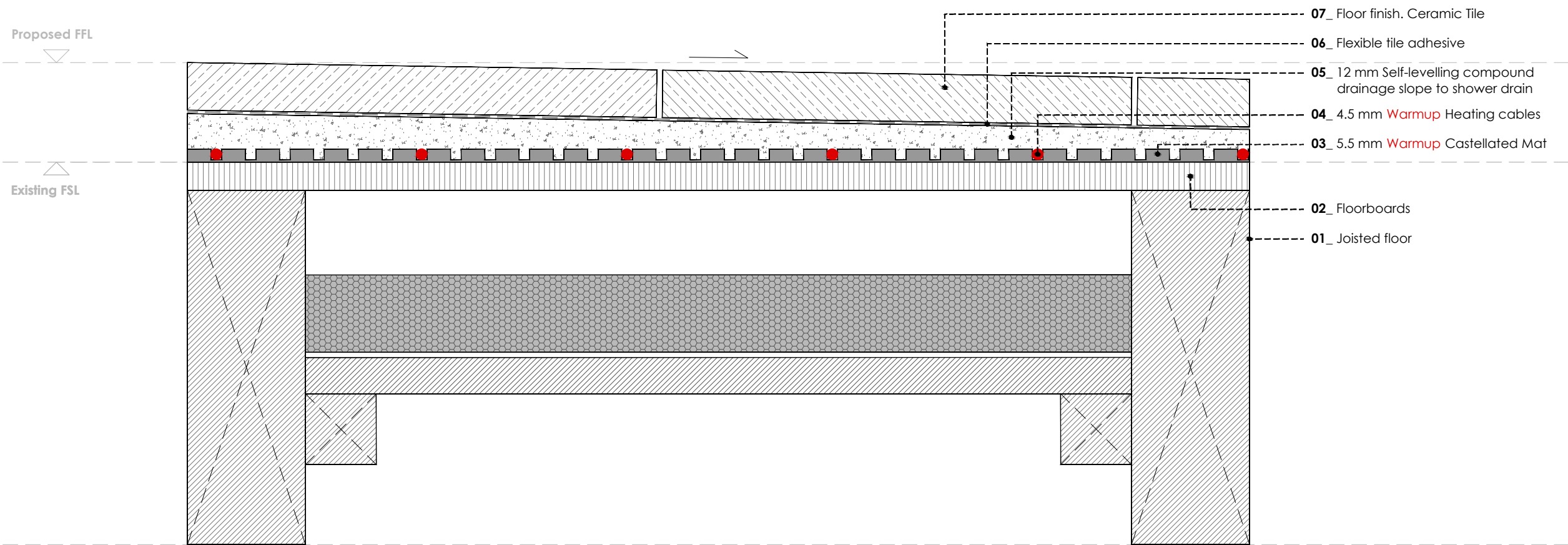

WARMUP CASTELLATED MAT SYSTEM.
TIMBER SUBFLOOR WITH DRAINAGE SLOPE FOR WETROOMS

© This drawing is confidential and may not be used, copied or disclosed to anyone without permission of Warmup Plc. The Copyright of these drawings remain the property of Warmup Plc. Do not scale from drawings, all dimensions to be checked on site. The Warmup word and associated logos are trade marks. © Warmup Plc. 2010 - Regd. TM Nos. 1257757, 4409926, 5265707. E & OE. Registered in England No. 2955213.

TITLE:	WARMUP CASTELLATED MAT SYSTEM		
SCALE:	1.2_ A3	DATE:	06.04.2016
DESIGNER:	AAM	VERSION:	01

Warmup®

The world's **best-selling** floor heating brand™

WARMUP PLC, 702 Tudor Estate, Abbey Road, London, NW10 7UW
 Tel 0845 034 8270 Fax 0208 453 6869
projects@warmup.com www.warmup.co.uk



Proposed FFL

Existing FSL

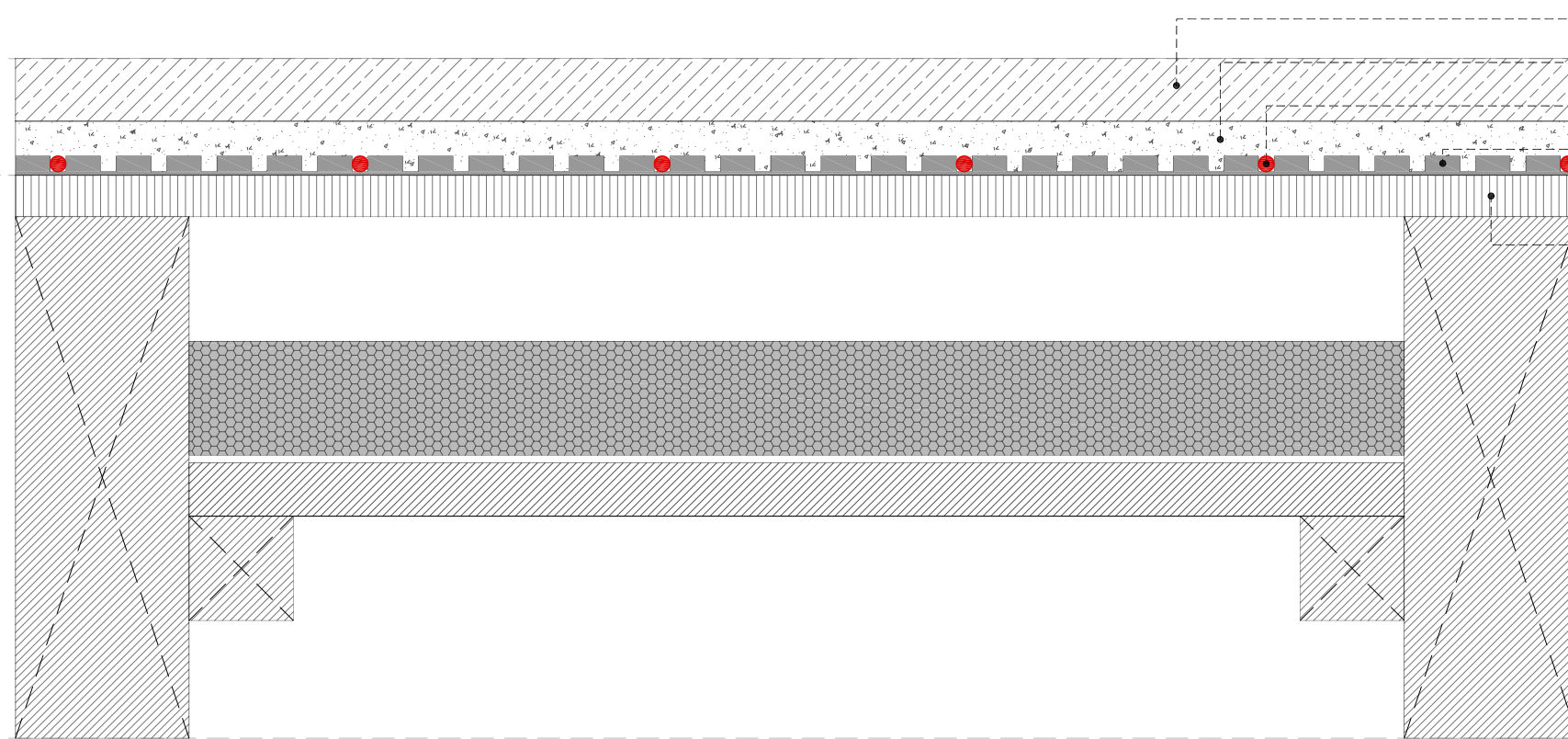

06_ Floor finish. Vinyl, Carpet or Wood

05_ 10 mm Self-levelling compound

04_ 4.5 mm Warmup Heating cables

03_ 5.5 mm Warmup Castellated Mat

02_ Floorboards

01_ Joisted floor

WARMUP CASTELLATED MAT SYSTEM.
TIMBER SUBFLOOR AND VINYL, CARPET OR WOOD

Warmup

The world's **best-selling** floor heating brand™

WARMUP PLC, 702 Tudor Estate, Abbey Road, London, NW10 7UW
 Tel 0845 034 8270 Fax 0208 453 6869
projects@warmup.com www.warmup.co.uk

© This drawing is confidential and may not be used, copied or disclosed to anyone without permission of Warmup Plc. The Copyright of these drawings remain the property of Warmup Plc. Do not scale from drawings, all dimensions to be checked on site. The Warmup word and associated logos are trade marks. © Warmup Plc. 2010 - Regd. TM Nos. 1257757, 4409926, 5265707. E & OE. Registered in England No. 2955213.

TITLE: WARMUP CASTELLATED MAT SYSTEM

SCALE: 1.2_A3 **DATE:** 06.04.2016

DESIGNER: AAM **VERSION:** 01